

TOOLS:

Drill
3/16 drill bit
Cutoff wheel or sawzall
Files round, flat
Miscellaneous hand tools
Wire stripper/crimper

RECOMMENDED:

Soldering iron
Heat Shrink tubing
Electrical butt connectors
Electrical tape
Spray adhesive

Park the vehicle in a well lighted area, disconnect the battery negative terminal and apply the parking brake

Plan out your installation. Read through the wiring diagram and plan your wiring route.

The panel should be mounted on a flat, supportive surface.

Using the supplied template, locate the best placement for the light panel. It is best to use a light coating of spray adhesive to adhere the template to the mounting surface to hold it steady

Drill a 3/16" hole at each mounting stud location. A 1/2" drill bit may be used to drill out the ends of the center section. Using a cutoff wheel, carefully remove the center section. Stay inside the template line, there is not much room for error here.

Test fit the light panel assembly use a file to adjust the opening if needed. Make sure it is right-side-up

The panel can be wired either with it in place, or by pulling the wires through the mounting hole and attaching to the wiring on the unit.

Wiring the unit:

NV-PNL-001 (small 7 lamp unit)
This part has inline resistors connected to the base of each LED. The lamps work on 11-16V and do not require any additional resistors to function properly.

Each LED lamp in the unit has its own Positive and negative wire. This allows the most installation flexibility for a variety of applications. You may be able to use a common ground on some of the connections. Not always (check your components first), but in general the following lamps are triggered this way:

Turn signal +
Shift lamp output+
Oil pressure warning lamp -
Electronic pumps, fans and motors +
Alternators and generators + and -
High beam +

Final Assembly

Insert the assembly into the panel holes that have been cut and test fitted. Using the fasteners provided, snug the nuts down to hold the assembly to the panel. Make sure the panel is right side up before final tightening.

INSTRUCTION SHEET REAR MOUNT INDICATOR PANELS

91017-01 7-LAMP REAR MOUNT INDICATOR ICONS HORIZ
91007-01 7-LAMP REAR MOUNT INDICATOR PRND321 HORIZ
91027-01 7-LAMP REAR MOUNT INDICATOR PANEL PRND321 VERT



NEW VINTAGE USA LLC
395 WEST CHESTERFIELD
FERNDALE, MI 48220
248.259.4964

www.newvintageusa.com

COVER BEZEL TEMPLATE/DIMENSIONS

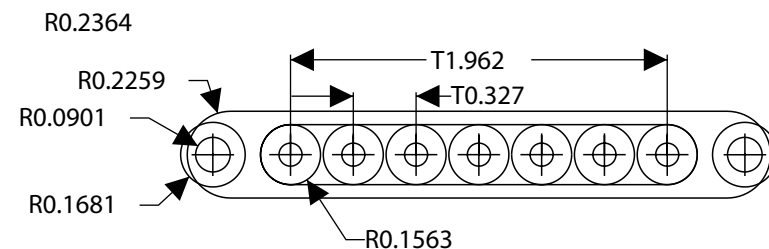
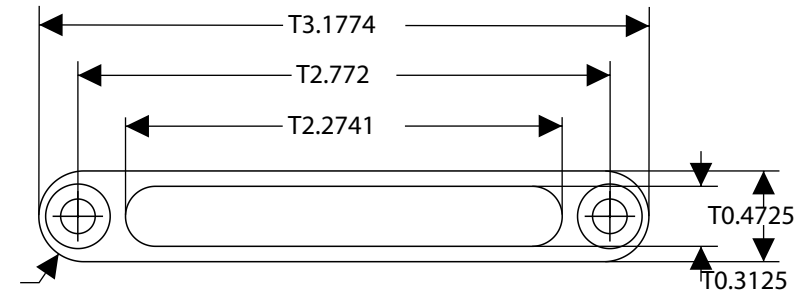

REAR MOUNT PANEL TEMPLATE/DIMENSIONS